

# App Marketplace - Self-provisioning Workflow - Udemy for Business

Udemy is an online learning and teaching marketplace that hosts online courses. If your company uses **Udemy**, you can integrate your Udemy content into SumTotal Learn so your learners can access all their training in one place.

For more on Udemy, please check their website ([www.udemy.com](http://www.udemy.com)).

## Configure and Activate Udemy Integration

From the SumTotal App Marketplace home page, find the integration connector app for **Udemy for Business**.

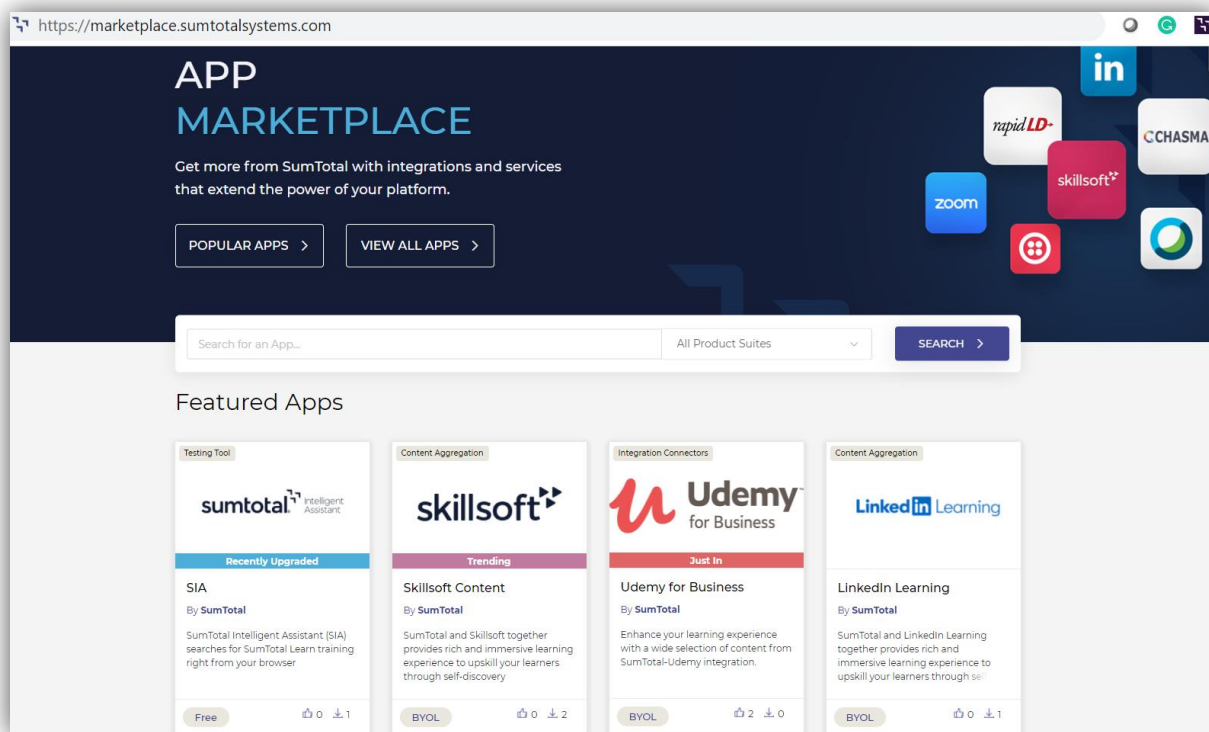

Hover over the listed **Udemy for Business** app and click **More Info** to navigate to the Udemy app details page.



sumtotal

SIGN IN >

MarketplaceWhat is Marketplace?FAQContact

Welcome Back

You can sign in with your username

Username

test7@sumt.com

Password

.....

☐ Remember Me

SIGN IN >

Forgot your [password?](#)

Don't have an [account?](#)

Log in to the SumTotal Marketplace. If you do not have an account, please click on the link to create one. On successful login to the Marketplace, the **Setup Environment** button appears.

Launch Udemy content from SumTotal LMS

sumtotal

Welcome

A STRAIGHT TALKING GUIDE TO UDEMY

About this course

Course content

1. Why U.S. and What's New Goal?

2. Introduction

3. Making a Plan

4. Choosing a Plan

5. Completion Analysis

Section 2: Planning Your Course

Section 3: Making the Course

Section 4: Establishing Trust

Section 5: Selling Your Course

Section 6: Wrap Up

Section 7: 2020 Updates, Settings, Billing

Udemy

Connect integration (2020) gateway

Integration Connectors

BYOL

Setup Environment >

Total Installs 0

Click **Setup Environment** to specify the environment for which you want to submit the installation request. The **Installation Environment** popup screen appears.

The screenshot shows the sumtotal marketplace interface with a user profile 'Test User 7' and email 'test7@sumt.com'. A navigation bar includes links for Marketplace, What is Marketplace?, FAQ, Contact, and Documentation. The main content area displays 'Udemy for' and a list of items. An 'Environment Setup' popup is overlaid, prompting the user to specify the environment for installation. The popup includes a dropdown menu for adding a new environment, input fields for the environment name and URL, and two checkboxes for regional customer status and terms agreement. The 'INSTALL' button is highlighted in blue.

On the **Installation Environment** pop up:

- Enter the environment or site name.
- Enter the environment or site URL.
- Select the checkbox if you are an **EMEA** (Europe, The Middle East, and Africa) region customer.
- Select the checkbox to agree to the terms and conditions.

Click **Install**. This redirects you to the SumTotal URL entered for installation.

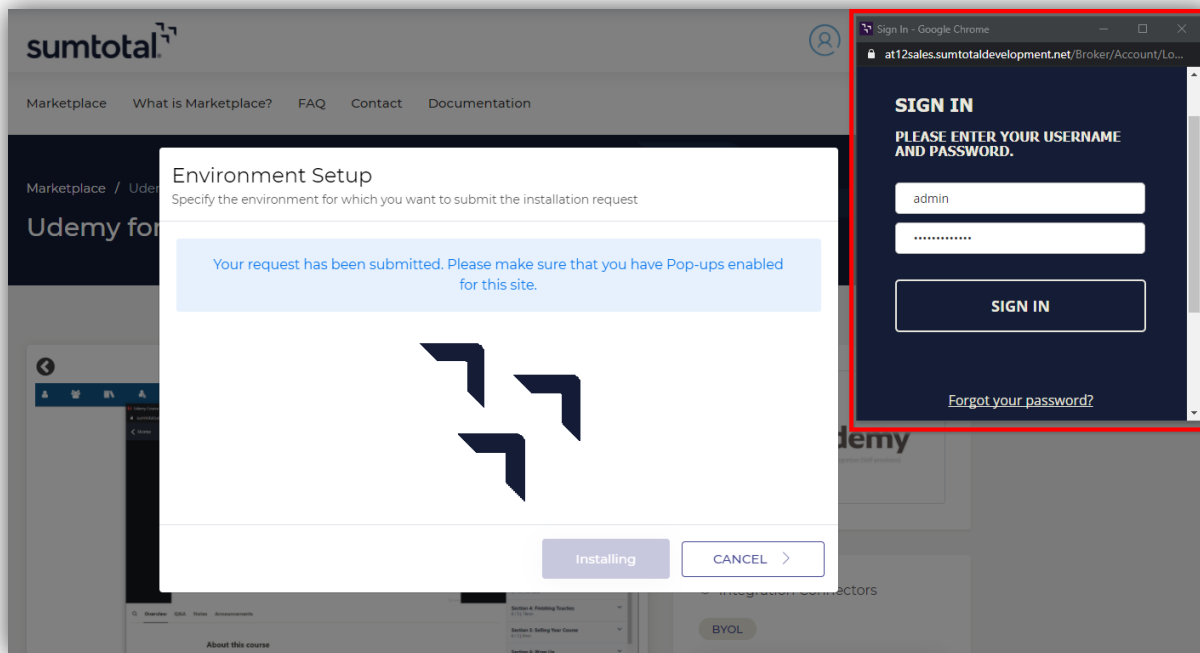

Enter the SumTotal Learning environment credentials.

Upon successful login to the environment, you receive a confirmation message that your installation request has been submitted.

Please wait for few seconds to complete the installation.

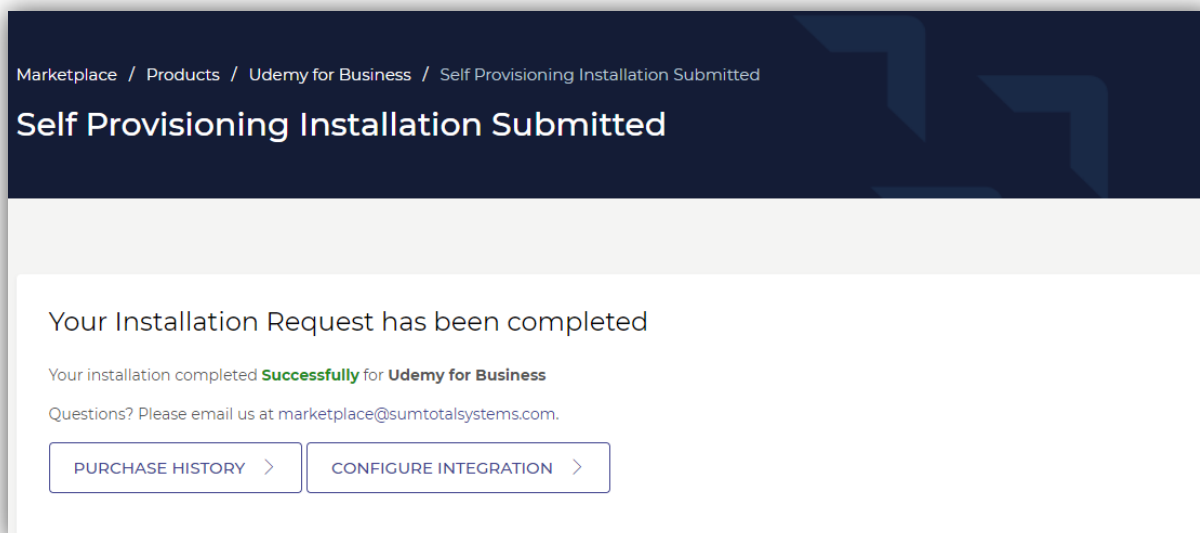

- **Purchase History** – Allows you to check all your purchase history. This page displays details for the apps installed, additional information such as environment name, installation status, purchase date, and a link to go back to the **Content Integration** page.

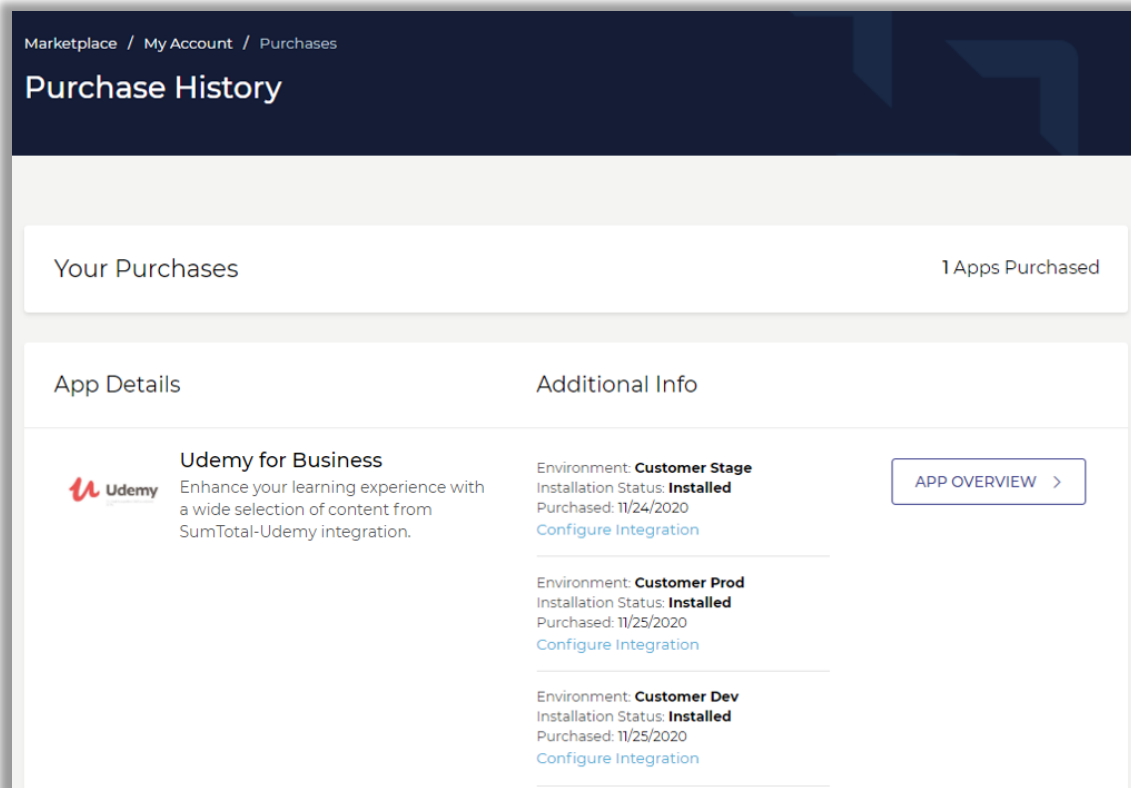

The **App Overview** button allows you to navigate back to the App Details page.

- **Configure Integration** – Enables you to configure the screen for integration.

Click **Configure Integration** to navigate to the **Content Integrations** page under your current working domain. Ensure that you are in the *required domain* to configure the settings.

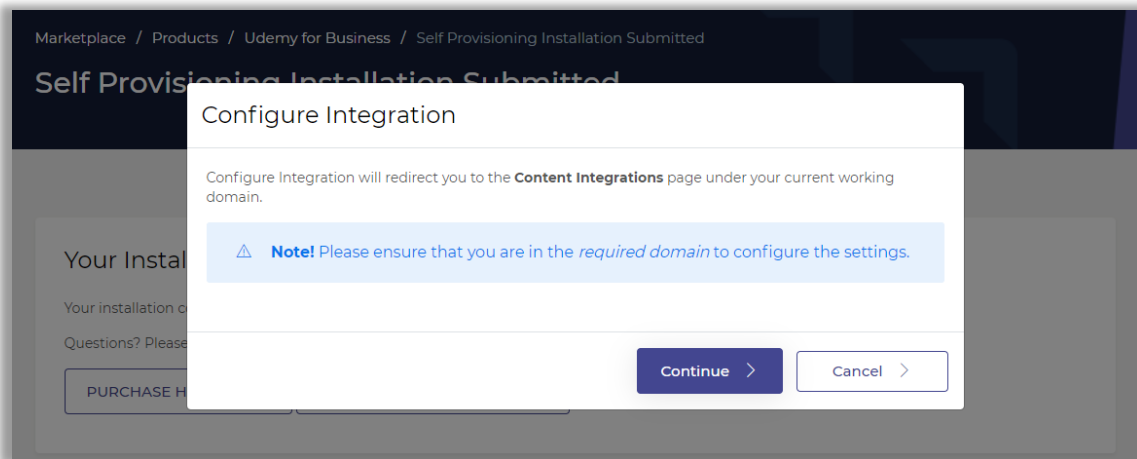

Click **Continue** to navigate to the **Content Integration** page.

The Content Integrations list page in the SumTotal environment will now display **Udemy for Business** entry created through Marketplace Self Provisioning. From here, you can edit integration properties as per needs.

CONTENT INTEGRATIONS					
Change the status of integrations or edit integration properties to suit your needs.					
<input checked="" type="radio"/> Activate <input type="radio"/> Deactivate <input type="button" value="Sync Data"/>					
<input type="checkbox"/>	Name ↕	Status	Last Sync Date ▼	Last Sync Status ↕	Actions
<input type="checkbox"/>	LinkedIn Learning	Inactive	6/27/2019 10:56:34 PM CEST	Success	<button>EDIT</button> ▼
<input type="checkbox"/>	Skillsoft	Active	6/16/2020 10:37:09 AM CEST	Failed	<button>EDIT</button> ▼
<input type="checkbox"/>	Udacity	Active	4/5/2019 1:42:56 PM CEST	Failed	<button>EDIT</button> ▼
<input type="checkbox"/>	edX	Inactive			<button>EDIT</button> ▼
<input type="checkbox"/>	Kpoint	Inactive			<button>EDIT</button> ▼
<input type="checkbox"/>	Udemy for Business	Inactive			<button>EDIT</button> ▼

Click **EDIT** alongside the Udemy for Business entry to open the Udemy Content Integrations Form Page.

Enter the default learning activity properties below. Learn will only apply these properties to learning activities synchronized in the future. Content is synchronized daily.

**Udemyl**

Udemyl for Business helps companies stay competitive in today's rapidly changing workplace by offering fresh, on-demand learning content through a powerful content marketplace. Our mission is to help employees do whatever comes next-whether that's the next project to tackle, skill to learn or role to master. We do this by curating a collection of 4,000+ of Udemyl's top-rated courses taught by the world's leading experts. Our content covers a variety of key business and technical topics ranging from Artificial Intelligence and IT to leadership, marketing, design and stress management. In addition to a curated content collection, organizations can also host and distribute their own proprietary content on Udemyl.

**Status**

☐ Activate

**Host Name \***

**Organization ID \***

**Client ID \***

**Client Secret \***

**TEST**

**ACTIVITY LAUNCH SETTINGS**

**Launch Mode \***

REDIRECT

**Unique User Identifier \***

PERSON ID

**Default Audience \***

**BROWSE**

**Prefix to Learning Activity Code**

**Suffix to Learning Activity Code**

**LIBRARY SYNCHRONIZATION SETTINGS**

Enter all the required details and then click **Save**.

You have now successfully created **Udemyl for Business** entry in the Content Integration page and configured it.

## Do you want to integrate with other environments?

Please continue with the following steps to integrate UdemY for Business for additional environments (Dev/Stage/Production).

Marketplace / UdemY for Business

UdemY for Business

Launch UdemY content from SumTotal LMS



Like

Share Link

UdemY

UdemY

UdemY for Business (Self-Service)

Integration Connectors

BYOL

INSTALL >

PURCHASE HISTORY >

Details

Installation Guide

Pricing

FAQs

Contact Info

Overview:

UdemY for business Cloud Integration will help organizations to stay competitive in today's rapidly changing workplace by offering fresh, on-demand learning content through a powerful content marketplace. Help your employees do whatever comes next- whether that's the next project to tackle, skill to learn or role to master. You can achieve this by importing a curated collection of 4,000+ of UdemY's top-rated courses taught by the world's leading experts. These content covers a variety of key business and technical topics ranging from Artificial Intelligence and IT to leadership, marketing, design and stress management.

App Information

Category: Learning Management

On the App Details page:

- The **Install** button enables you to add a new environment or install the app for any previously available environment.
- The **Purchase History** button shows details of all your purchases.

sumtotal

Marketplace / Ude

### Environment Setup

Specify the environment for which you want to submit the installation request

The following environments are available. Environments can be managed in your Profile

----- Add new Environment -----

Environment Name

Customer Production Site

Environment URL

https://AT12SALES.sumtotaldevelopment.net

☐ Check The Box If You Are An EMEA (Europe, The Middle East, And Africa) Region Customer.

☒ Check Here To Indicate That You Have Read And Agree To Our Terms And Conditions

INSTALL > CANCEL >

From the **Environment Setup** screen, please follow the steps as mentioned previously.

**Note:** For further assistance on Self-provisioning Workflow, please reach out to SumTotal Marketplace Team: [marketplaceadmin@sumtotalsystems.com](mailto:marketplaceadmin@sumtotalsystems.com).